

Installation Instructions

I- Sheet Number WIN160 Rev.C



Ventvisor® Deflector

**For proper installation and best possible fit, please read all instructions BEFORE you begin.
For technical assistance or to obtain missing parts, please call Customer Relations at 1-800-344-8759.**

Important Safety Information



- CAUTION - Before driving, ensure that the vent visors are properly secured to vehicle.
- Do not use automatic "brush-style" car washes.
- Do not use cleaning solvents of any kind.
- Periodically check all components for tightness.
- When using Surface Prep, avoid contact with skin. Use in well ventilated area. If contact is made with material, flush area with large amounts of water. If irritation persists, get immediate medical attention. USE PREP ON RUBBER ONLY

Contents - 2 Piece Set

NOTE: Actual product may vary from illustration.



Front Driver
Side Visor



Front Passenger
Side Visor



Alcohol Pad x2



Scotch Brite Pad



Surface Prep

Contents - 4 Piece Set



Front Driver
Side Visor



Front Passenger
Side Visor



Rear Driver
Side Visor



Rear Passenger
Side Visor



Alcohol Pad x4



Surface Prep x2

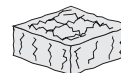

Scotch Brite Pad

Tools Required



Car Wash Supplies



Clean Towel



Safety Gloves

Preparation Before Painting / Installation

- A trial fit is recommended to ensure proper positioning and fit.
- Check fit of parts before painting as we will not accept the return of modified or painted parts.
- Wash and dry your vehicle to remove any debris and/or dirt from the installation area.
- **Ensure vehicle surface and part are above 60°F (15°C) prior to installation.**



60°F+
33°C+

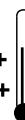

Installation Steps

NOTE: Actual application may vary slightly from illustrations.



Alcohol Pad

Scuff the rubber trim where the visor will mount with the scotch brite pad. Then clean the trim with an alcohol pad and wipe dry. Repeat on opposite door.

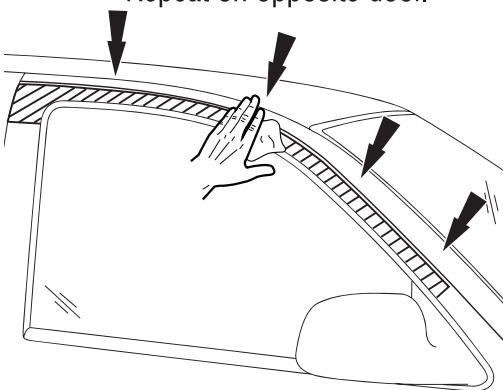

1



Apply one coat of surface prep to the previously cleaned rubber trim on both front doors promptly to prevent evaporation.

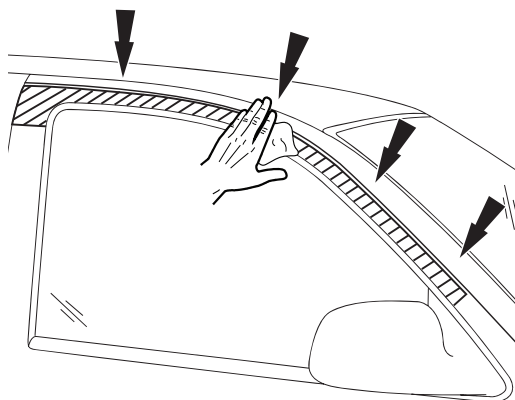

2

Peel back 2" of tape liner from back of front visor at each end of top flange. Remove tape liner completely at rear flange.

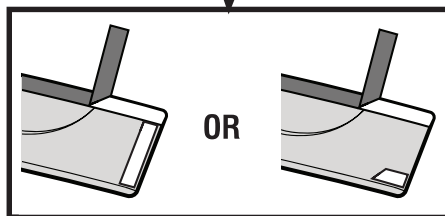
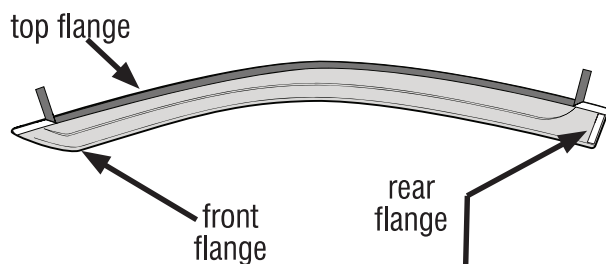

3

Align front visor with previously cleaned surface.

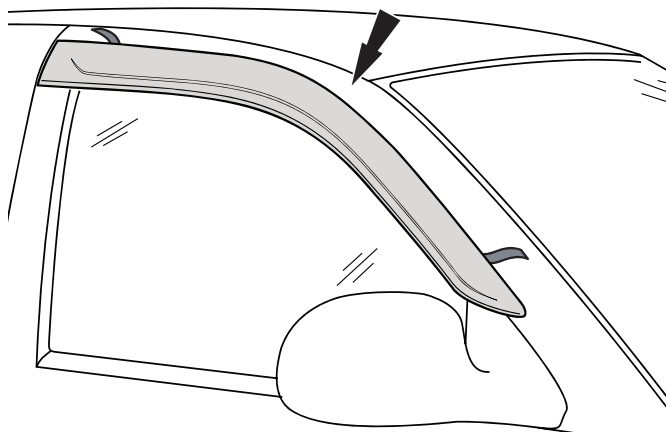

4

Remove remaining tape liner.

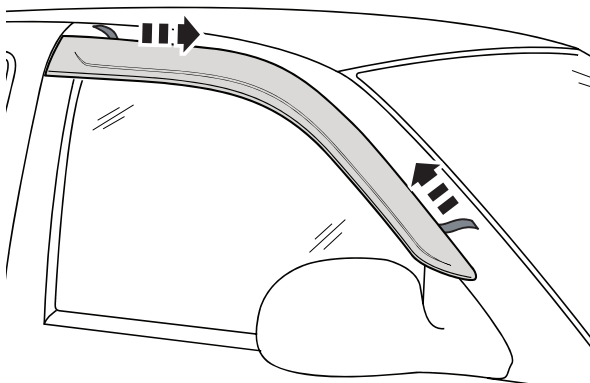

5

Apply pressure to secure visor to vehicle.

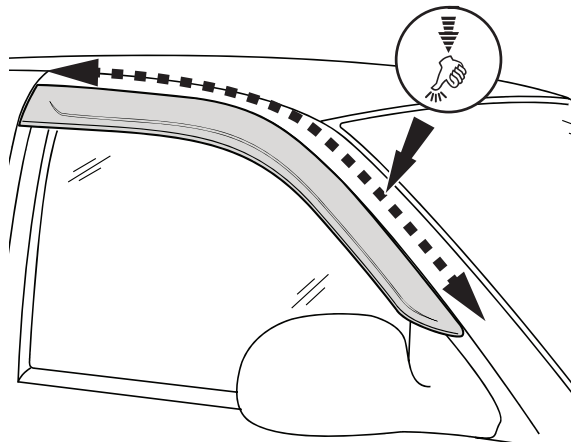

6

Repeat above steps for opposite side.

Installation Steps

NOTE: Actual application may vary slightly from illustrations.

Rear Visor Installation Steps

The drivers side rear visor attaches to the rubber trim utilizing the same procedure.

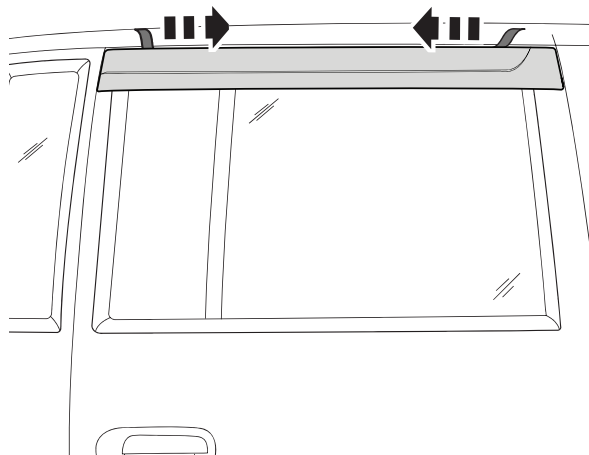

7

Repeat for opposite side.



Example of completed installation

Care and Cleaning

- Wash only with mild soap & dry with a clean cloth.



The material that your product is made from can be recycled. Please also consider recycling the packaging that your product came in.



Congratulations!

You have purchased one of the many quality Husky® branded products. We take the utmost pride in our products and want you to enjoy years of satisfaction from your investment. We have made every effort to ensure that your product is top quality in terms of fit, durability, finish and ease of installation.



1-800-344-8759 • Visit us at huskyliners.com

© 2025 Husky Liners, Inc. All rights reserved.

Husky® and the Husky® logo are trademarks of Husky Liners, Inc.