

# Installation Instructions

I - Sheet Number INS-HS124 Rev.B



## Hood Shield

**For proper installation and best possible fit, please read all instructions BEFORE you begin.**  
**For technical assistance or to obtain missing parts, please call Customer Relations at 1-800-344-8759.**

### Important Safety Information



- CAUTION - Before driving, ensure that the hood shield is properly anchored to vehicle.
- Do not use automatic "brush-style" car washes.
- Do not use cleaning solvents of any kind.
- Periodically check all components for tightness.

### Contents **NOTE:** Actual product may vary from illustration.



Hood Shield



Bump On  
x4



Washer x6  
(98022)

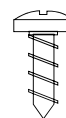

Screws x6  
(98023)

### Tools Required



Car Wash Supplies



Clean Towel

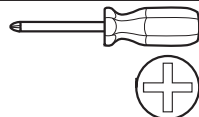

Phillips Screwdriver

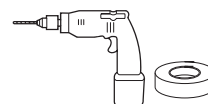

Drill with 1/8" bit  
and 1/2" stop collar



Grease pencil

### Preparation Before Painting / Installation

- A trial fit is recommended to ensure proper positioning and fit.
- Check fit of parts before painting as we will not accept the return of modified or painted parts.
- Wash your vehicle's hood to remove any debris and/or dirt.
- Dry the hood with a clean towel.
- Do NOT install hood shield if vehicle does NOT have a factory installed hood seal / gasket.

### Installation Steps **NOTE:** Actual application may vary slightly from illustrations.

Open hood. Note the location of rubber seal on leading edge of hood. Use car wash supplies to clean the hood surface area underneath the rubber seal.

Rubber seal

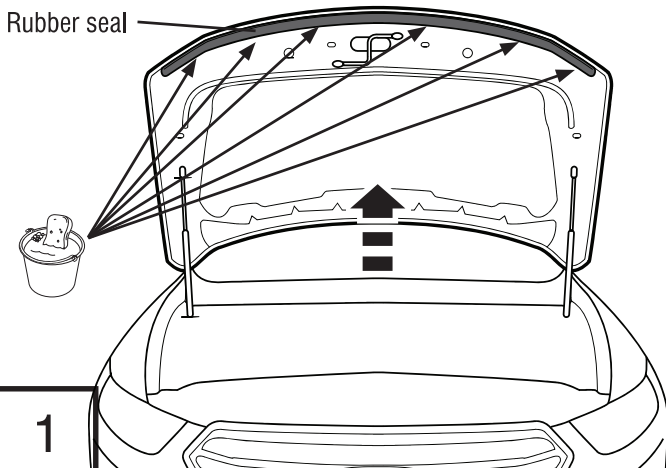

1

Center hood shield in place on hood. Use a grease pencil to mark the locations on rubber seal that correspond to (6) holes on hood shield flange.

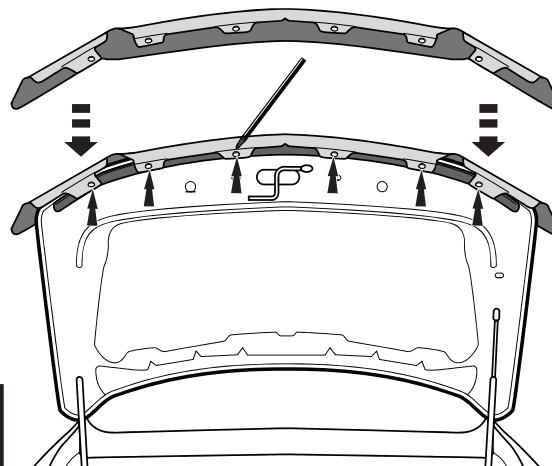

2

## Installation Steps

**NOTE:** Actual application may vary slightly from illustrations.

Remove red tape liner from (6) hood shield flanges to expose adhesive.

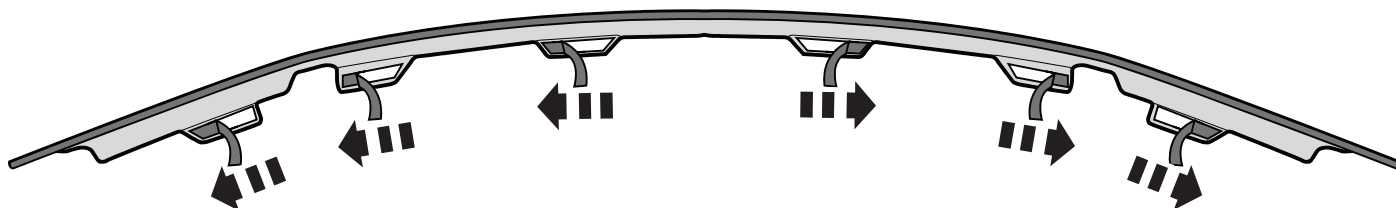

3

Reposition the hood shield on the hood with the flanges sliding **between** the hood and rubber seal. Firmly press adhesive tape to adhere hood shield to hood surface.

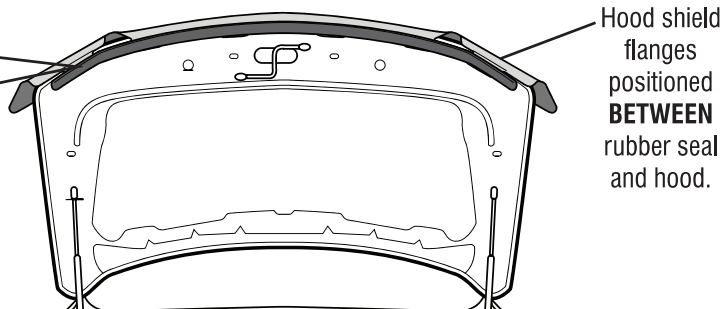
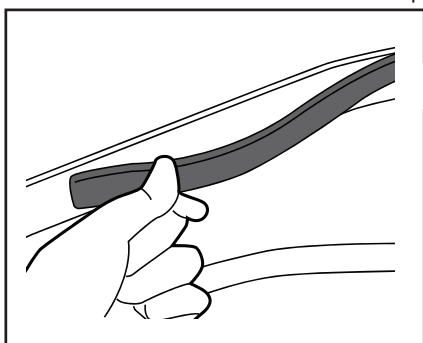

4



**NOTE:** Exercise extreme caution not to tear or damage the rubber seal when separating from hood.

## Optional Screw Attachment

Use a drill with a 1/8" bit and a 1/2" stop collar to drill a pilot hole at each flange location. **NOTE:** Use caution not to drill through the opposite side of the hood!

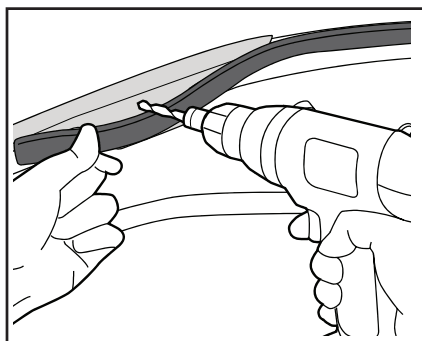
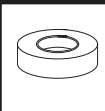
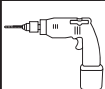

X6

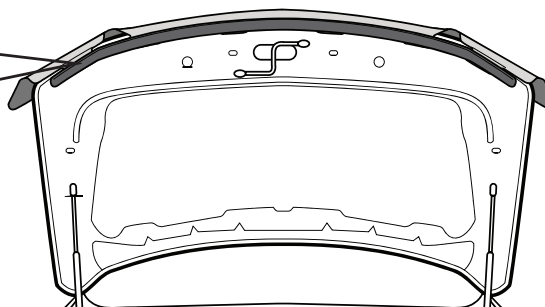

5

Install (1) screw with (1) washer through hood shield flange and into hood. Repeat for remaining locations.

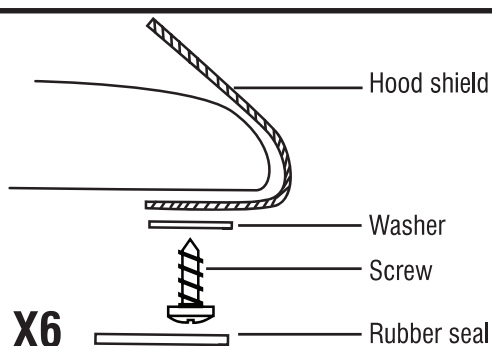
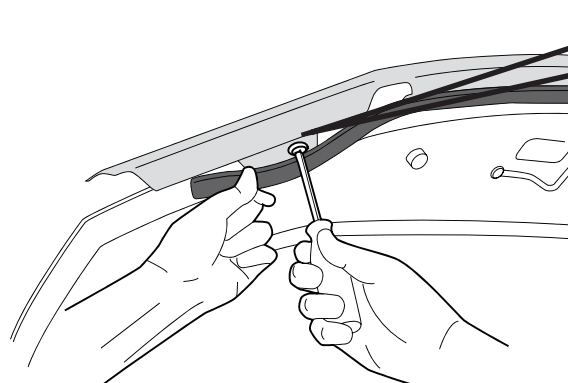
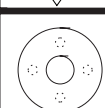
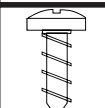

X6

6

## Installation Steps

**NOTE:** Actual application may vary slightly from illustrations.



Tighten all (6) screws until snug to secure hood shield to hood.

**X6**

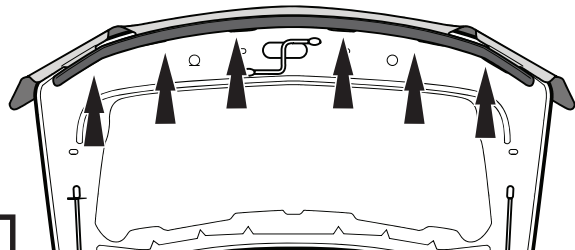

**7**

**NOTE:** DO NOT OVER TIGHTEN

**8**

Close Hood.

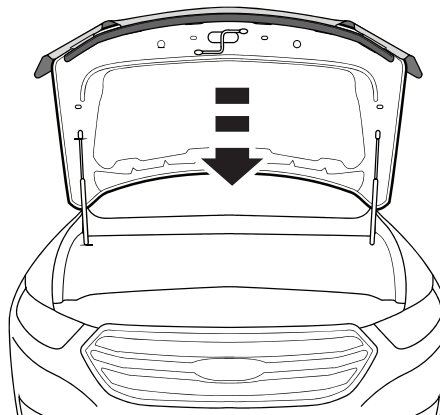

Apply bump ons to surface of hood

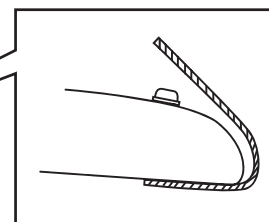
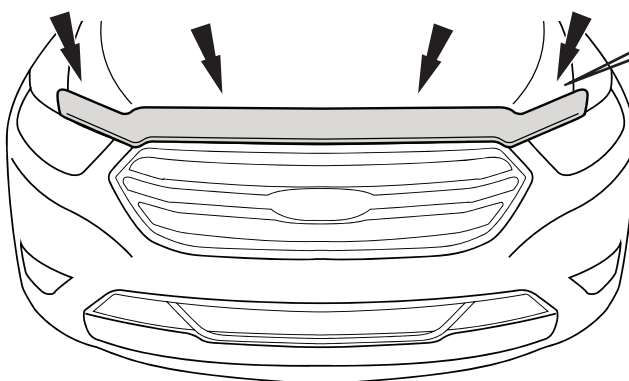

**X4**

**9**

## Care and Cleaning

- Wash only with mild soap & dry with a clean cloth.



The material that your product is made from can be recycled. Please also consider recycling the packaging that your product came in.



## Congratulations!

You have purchased one of the many quality Husky® branded products. We take the utmost pride in our products and want you to enjoy years of satisfaction from your investment. We have made every effort to ensure that your product is top quality in terms of fit, durability, finish and ease of installation.



1-800-344-8759 • Visit us at [huskyliners.com](http://huskyliners.com)

© 2024 Husky Liners, Inc. All rights reserved.

Husky® and the Husky® logo are trademarks of Husky Liners, Inc.