



# INSTALLATION MANUAL

## 13466-SK

**THIS SERVICE KIT IS TO BE USED WITH CURT TRAILER HITCH #13462.**

### Level of Difficulty

Easy

Installation difficulty levels are based on time and effort involved and may vary depending on the installer level of expertise, condition of the vehicle and proper tools and equipment.

### Weight Carrying Capacity

Gross trailer weight (GTW)	4,000 lbs.
Tongue weight (TW)	400 lbs.

### Weight Distribution Capacity

Weight distribution (WD)	5,000 lbs.
WD tongue weight (WDTW)	500 lbs.

### Parts List

Item	Qty	Description
1	2	Mounting bracket, driver side
2	2	Hex bolt, M8-1.25 x 30mm, class CL8.8
3	1	Hex bolt, 1/4"-20 x 1", grade 5
4	2	Nylock nut, M8-1.25
5	1	Nylock nut, 1/4"-20
6	4	Flat washer, 5/16"
7	1	Flat washer, 1/4"

### Tools Required

Ratchet	Wrench, 3/8"
Torque wrench	Wrench, 13mm
Socket, 3/8"	Universal joint
Socket, 13mm	Safety glasses

\* For a tools reference guide visit [curtmfg.com/trailer-hitch-installation](http://curtmfg.com/trailer-hitch-installation)

### ⚠ WARNING

Never exceed the vehicle manufacturer's recommended towing capacity.

### Product Photo



### NOTICE

Visit [www.curtmfg.com](http://www.curtmfg.com) for a full-color copy of this instruction manual, as well as helpful videos, guides and much more!

Before you begin installation, read all instructions thoroughly.

Proper tools will improve the quality of installation and reduce the time required.

This service kit is to be used with CURT trailer hitch #13462.

Periodic inspection of the trailer hitch should be performed to ensure all mounting hardware remains tight and structural components are secure.

To help prevent damage to the product or vehicle, refer to the specified torque specifications when securing hardware during the installation process.

### SAFETY INSTRUCTIONS

Safety glasses should be worn at all times while installing this product.

### Product Registration and Warranty

CURT stands behind our products with industry-leading warranties. To get copies of the product warranties, register your purchase or provide feedback, visit: [warranty.curtgroup.com/surveys](http://warranty.curtgroup.com/surveys)

# ASSEMBLY

## Parts List

Item	Qty	Description
1	2	Mounting bracket, driver side
2	2	Hex bolt, M8-1.25 x 30mm, grade CL8.8
3	1	Hex bolt, 1/4"-20 x 1", grade 5
4	2	Nylock nut, M8-1.25
5	1	Nylock nut, 1/4"-20"
6	4	Flat washer, 5/16"
7	1	Flat washer, 1/4"

## Step 1

Complete Steps 1 through 3 on the instruction sheet provided with your CURT #13462 trailer hitch hardware kit.

## Step 2

Lower the carbon canister by removing the two bolts located on the bottom of the driver side frame. Return the bolts to the vehicle owner.

## Step 3

If applicable, remove the ground wire by removing the two bolts located on the bottom of the driver side frame.

## Step 4

Transfer the ground wire by fastening it to the existing driver-side end panel hole with the provided 1/4" hex bolt (#3), 1/4" flat washer (#7) and 1/4" nylock nut (#5).

**Note:** Ensure that the area with the electrical connection is free of paint, dirt and rust for suitable grounding.

## Step 5

Loosely secure the provided mounting brackets (#1) to the carbon canister with the two M8 hex bolts (#2), four 5/16" flat washers (#6) and two M8 nylock nuts (#4).

## Step 6

Complete Steps 4 and 5 on the instruction sheet provided with your CURT #13462 trailer hitch hardware kit.

## Step 7

First, raise the trailer hitch into position by sliding the passenger side of the hitch over the muffler. Feed the previously installed fishwires through the three holes, on the hitch on both sides, until all the bolts are through the hitch holes.

Remove one fishwire and loosely secure one serrated-flange nut on the bolt in the rearmost hole on each side.

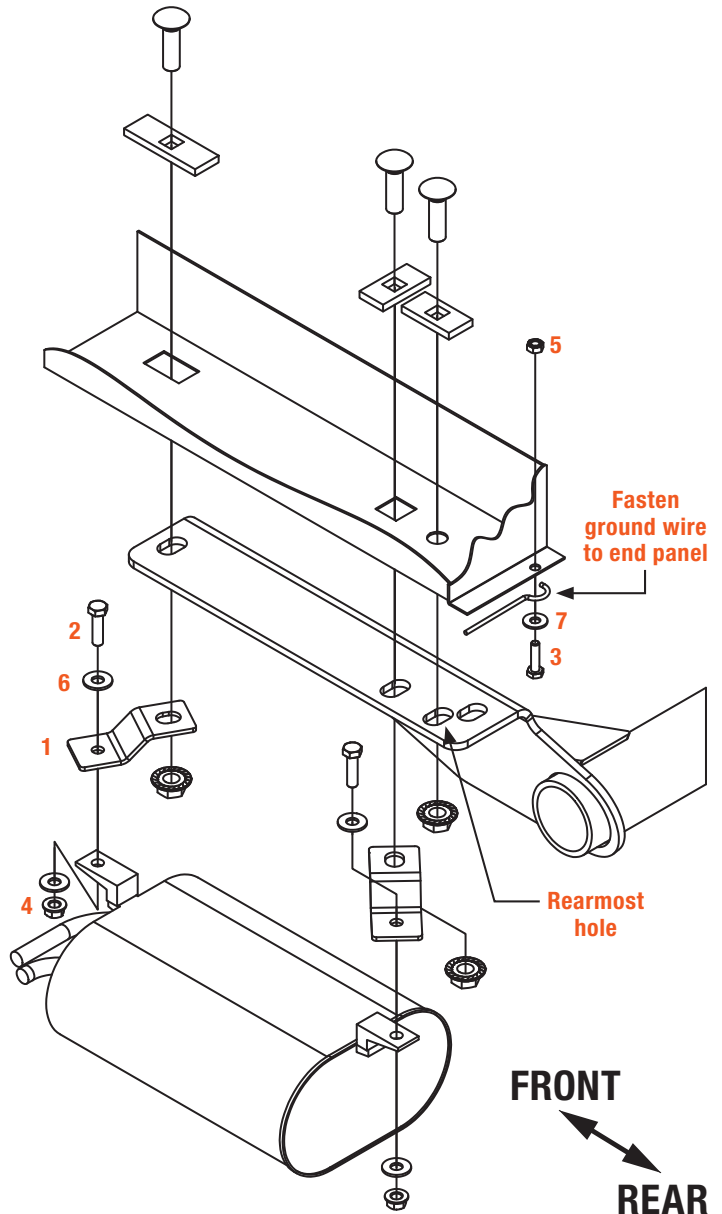

## Step 8

Reinstall the carbon canister by removing the remaining two fishwires on each side. Raise the canister until the two 1/2" carriage bolts without nuts on the driver side are in the slots of the two mounting brackets. Hand tighten the remaining two serrated-flange nuts on each side.

## Step 9

Torque all M8 fasteners to 16 lb-ft.  
Torque all 1/4" fasteners to 122 in-lb.  
Torque all 1/2" fasteners to 110 lb-ft.

Complete Steps 7 and 8 in the instruction manual provided with your trailer hitch (#13462).

## TOWING BASICS & SAFETY INFORMATION

For information on safely towing your trailer, visit [curtmfg.com/understanding-towing](http://curtmfg.com/understanding-towing).